

Mini Mash

To help your child with learning at home we have set up access to Mini Mash. This is a safe online learning site for young children. Here is a quick introduction to help you and your child get started.

<https://www.purplemash.com/sch/whitchurch-infant>

I would strongly recommend watching the getting started video and exploring with your child the first few times they go on the site. This is not a site they have been on themselves so they may need some support to begin with.

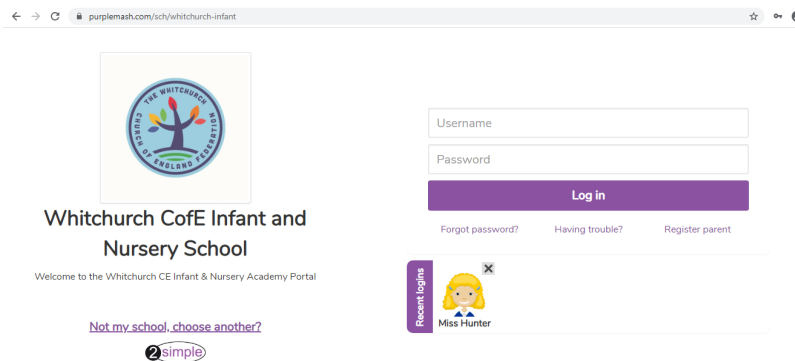

This is the login page. User name and password is attached to this letter. We have set the password to be 2 pictures to make it as simple as possible. When you click in the password box pictures will pop up to choose from. After the first time of logging they will appear in the recent log in section, like mine has! Next time they log in, click on it and it will automatically fill in the username but the password will still need adding

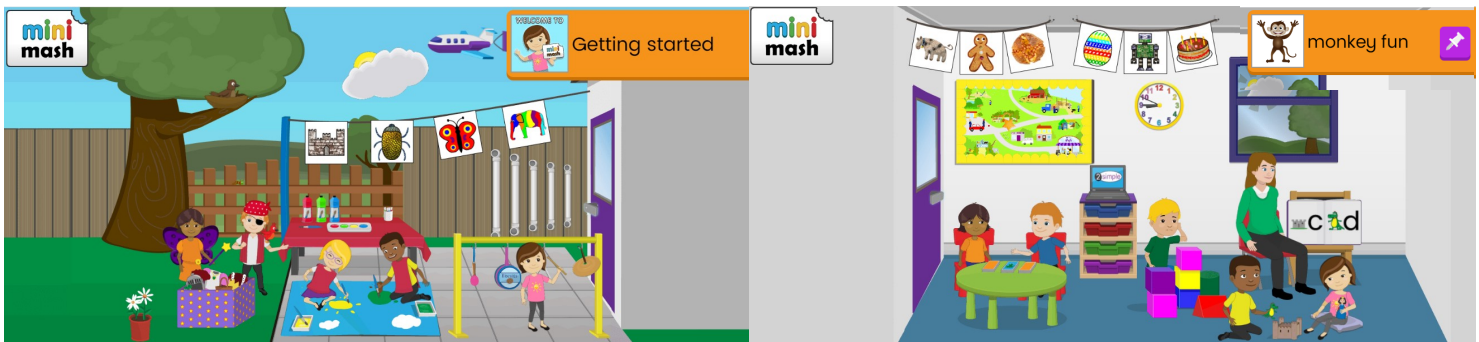

When you enter the site looks like a nursery! Clicking on the door will take you in and out. Clicking on different things will open up menus, games and make things happen, so explore, see what you can find and do!

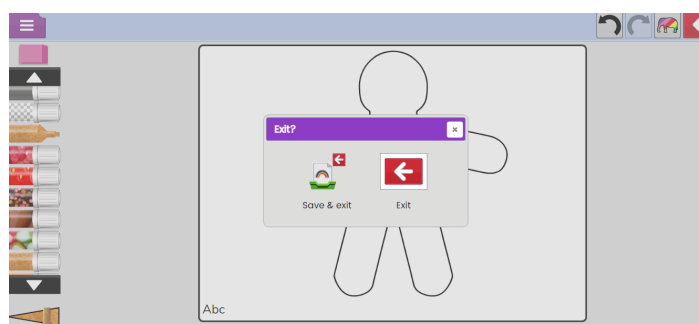

Red rectangle with a white arrow will take you out of the activity and back to the Nursery.

Some activities will give a save option as above . Save and exit will save by automatically naming and dating the activity and will go in your child's "tray" . By clicking on the trays in the nursery your child can access their saved items.

How to access our Home Learning



Click on the purple drawing pin for a drop down menu of games collections.

Click on the picture to open the menu.

Each week of learning will have a selection of videos, activities and games.



Games look like this.

MP4 are videos of learning and stories.



Paint activities look like this

A PDF file called task mat has an overview of learning for Parents.

We have recorded instructions for the games to help children to play. Clicking on the green square with a white triangle will play more instructions.

